

SSMLB-EL70U

INGROUND LANDSCAPE LIGHT
5w | 346lm - 8w | 507lm



MOTORIZED RETRACTABLE LIGHT

Wall Washing | Accent Lighting

Imagine a world where your landscape lights rise at dusk to beautifully illuminate your pathways, gardens, or architecture—then disappear by dawn, leaving no visual clutter.

Introducing the first-ever motorized retractable landscape light, engineered for both form and function. Perfect for landscape architects, lighting designers, and maintenance teams seeking innovation with elegance.

Our retractable motorized Landscape Light is perfect for pathway and area lighting. Single-sided upward light distribution with adjustable beam angles from 0-45 degrees and with multiple beam options. Multiple color temperatures are available. 4 levels of brightness are able to be selected when powered on.

When powered on, the fixture raises to max height and when powered off, fixture retracts to be flush with ground level.

Works with standard 12vac landscape transformer.

Features:

- *Extruded aluminum housing & stainless steel*
- *Single-sided upward lighting*
- *Adjustable projection angle: 0° - 45°*
- *Beam Angle Options: 30°, 30x60°, 60° & 90°*
- *Polycarbonate clear Lens*
- *4 brightness levels available for adjustment*
- *IP66 waterproof*
- *Winter mode setting*
- *CCT Options : 2700K / 3000K / 4000K / 5000K*
- *3 Year Warranty*

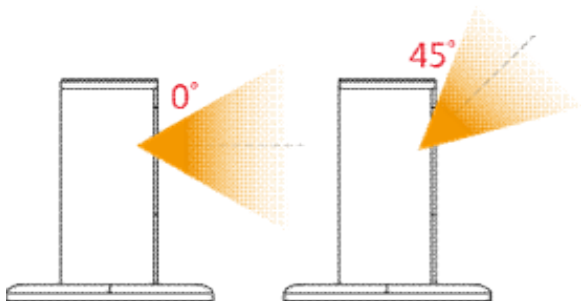

Diameter	2.8" x 2.8"
Raised Height	6"
Wattage (Max.)	5w/8w
Input Voltage	AC10-18V

SPECIFICATIONS

Firm:

Technical drawing of the top view of a circular plate. The outer diameter is 5.9" (150 mm). The central square hole has a side length of 2.8" (70 mm). The four corner holes are arranged in a square pattern with a side length of 2.8" (70 mm).

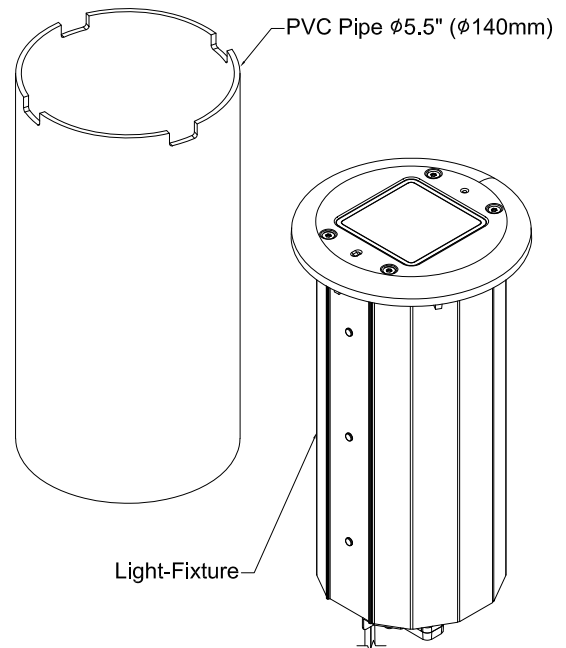
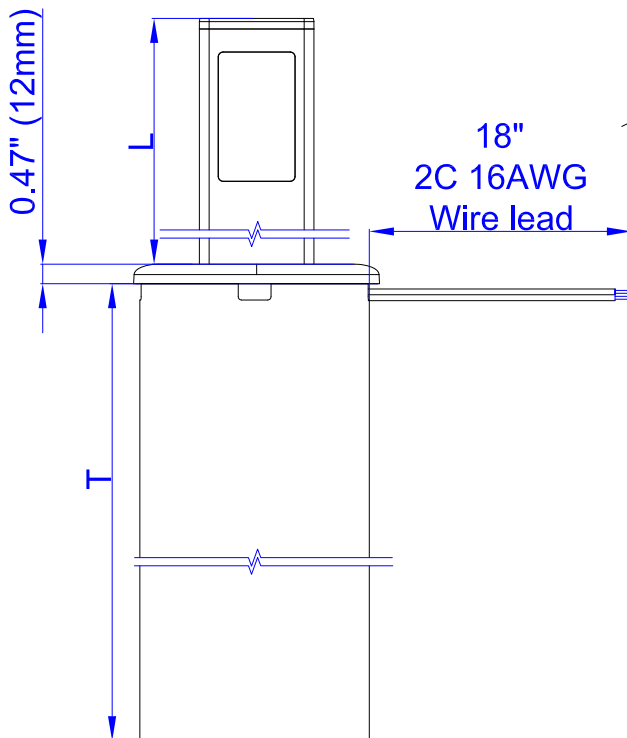

SSMLB-EL70US- 5W - Single Sided Illumination with adjustable beam angle

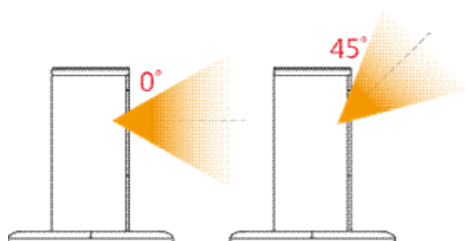

Physical

SSMLB-EL70US-6-xxK-xxD		
Light Fixture		
Material	Stainless Steel & Extruded Aluminum	
Finishing	Powder Coated Black	
Dimensions	2.8" x 2.8" (70mm x 70mm)	
Raised Height	5.9" (150mm)	
Environment	IP66	
Lens	Polycarbonate Clear Lens	
Fixture Base		
Material	Extruded Aluminum & PVC Pipe	
Pipe Diameter	Ø5.5" (Ø140mm)	
Pipe Height	11" (279mm)	
Installation Recommended Hole Size	Diameter	Ø7.9" (Ø200mm)
	Depth	13" (330mm)

Performance

Color Temperature Options	2700K , 3000K , 4000K , 5000K
Beam Angle Options	30° / 30°x60° / °60 / 90°
Adjustable Projection Angle	0°~45°
Lumen Output	TBD
Adjustable Brightness	4 brightness levels available for adjustment
Operating Temperature	0°C to +50°C, 32°F to 122°F

Electrical

Input Voltage	AC10-18V
Power Consumption	5w/pc.
	*The light consumes a maximum of 12W when it is rising up while powered on.

SSMLB-EL70UD- 8W - Single Sided Illumination with adjustable beam angle

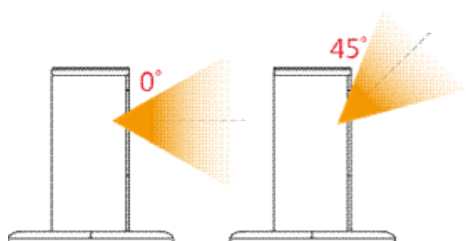

Physical

	SSMLB-EL70UD-6-xxK-xxD	
Light Fixture		
Material	Stainless Steel & Extruded Aluminum	
Finishing	Powder Coated Black	
Dimensions	2.8" x 2.8" (70mm x 70mm)	
Raised Height	5.9" (150mm)	
Environment	IP66	
Lens	Polycarbonate Clear Lens	
Fixture Base		
Material	Extruded Aluminum & PVC Pipe	
Pipe Diameter	Ø5.5" (Ø140mm)	
Pipe Height	11" (279mm)	
Installation Recommended Hole Size	Diameter	Ø7.9" (Ø200mm)
	Depth	13" (330mm)

Performance

Color Temperature Options	2700K , 3000K , 4000K , 5000K
Beam Angle Options	30° / 30°x60° / °60 / 90°
Adjustable Projection Angle	0°~45°
Lumen Output	507 lm @3000K 、 30°
Adjustable Brightness	4 brightness levels available for adjustment
Operating Temperature	0°C to +50°C, 32°F to 122°F

Electrical

Input Voltage	AC10-18V
Power Consumption	8w/pc.
	*The light consumes a maximum of 12W when it is rising up while powered on.

SSMLB-EL70U

ORDER FORM

Date: _____
Type: _____
Project: _____
Firm: _____

CREATE YOUR FIXTURE

SSMLB-EL70UD-xx"-xxK-xxD

MODEL

SSMLB-EL70UD	5W
SSMLB-EL70US	8W

RAISED HEIGHT

6"	6 inches
----	----------

COLOR

27k	2700k
30k	3000k
40k	4000k
50k	5000k

BEAM

30	30°x30°
60	60°x60°
90	90°x90°
3060	30°x60°

